

This document is the property of Evapco, Inc. It should not be copied or disclosed without prior written authorization.

EVAPCO, INC.



CUSTOMER

MODEL #	SSTMB1-11103H0050F4KA
---------	-----------------------

SCALE **N.T.S.**

DWG. # STMC1-SE-16

REV.	0
------	---

DATE	5/16/2024
------	-----------

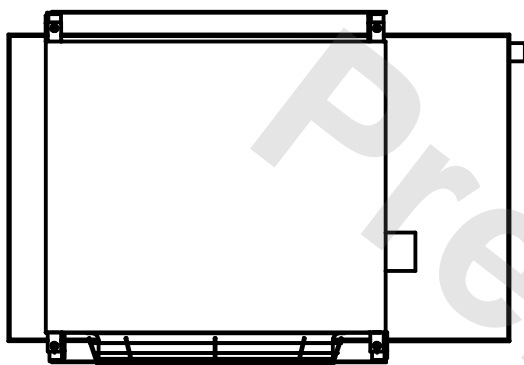

- 1) * = HANGER HOLE LOCATION.
- 2) RIGHT HAND MODEL SHOWN.
- 3) HANGER HOLES ARE FOR 3/4 INCH THREADED ROD.
- 4) WATER DEFROST ADDS 1 3/4" INCHES TO HEIGHT OF STANDARD UNIT AND CHANGES DRAIN SIZE.
- 5) ALL DIMENSIONS ARE FOR REFERENCE AND SHOULD NOT BE USED FOR PREFABRICATION OF PIPING OR SUPPORTS.

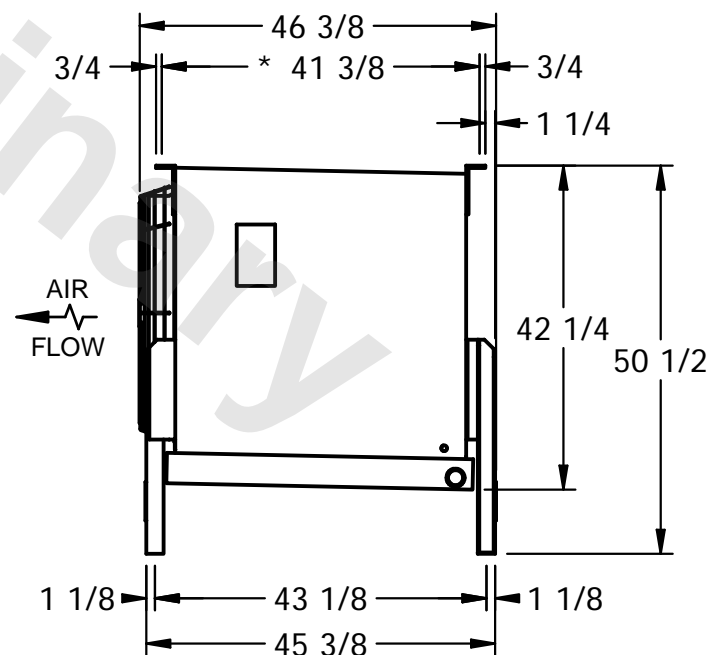

PROJECT

ROOM

SHIPPING WEIGHT	760 lbs
-----------------	---------

OPERATING WEIGHT	860 lbs
------------------	---------