

This document is the property of Evapco, Inc. It should not be copied or disclosed without prior written authorization.

MODEL #	U-EJETME2-2183H0100F1JA
---------	-------------------------

DWG. # UEJETM2-SE-16,18

DATE	7/27/2025
------	-----------



- NEMA 4X
JUNCTION BOX

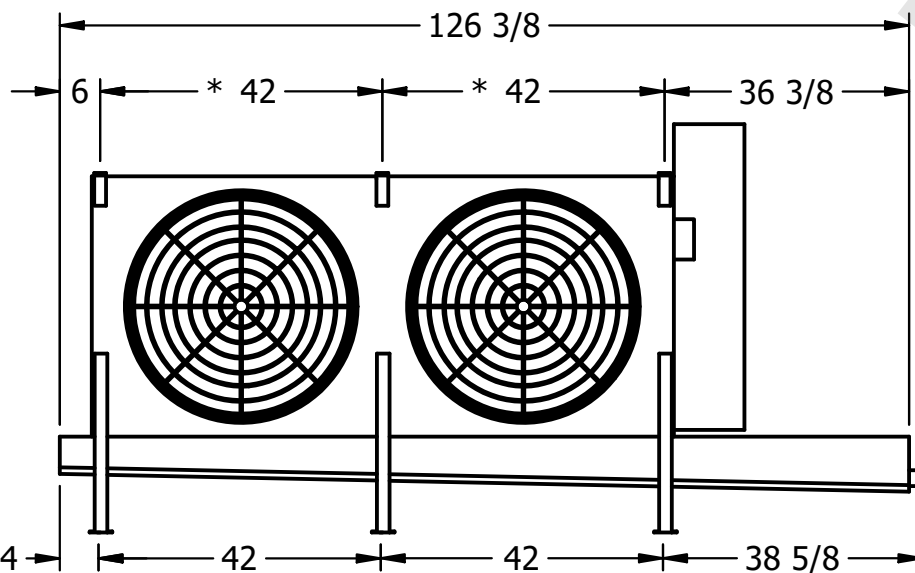

2" MPT
DRAIN

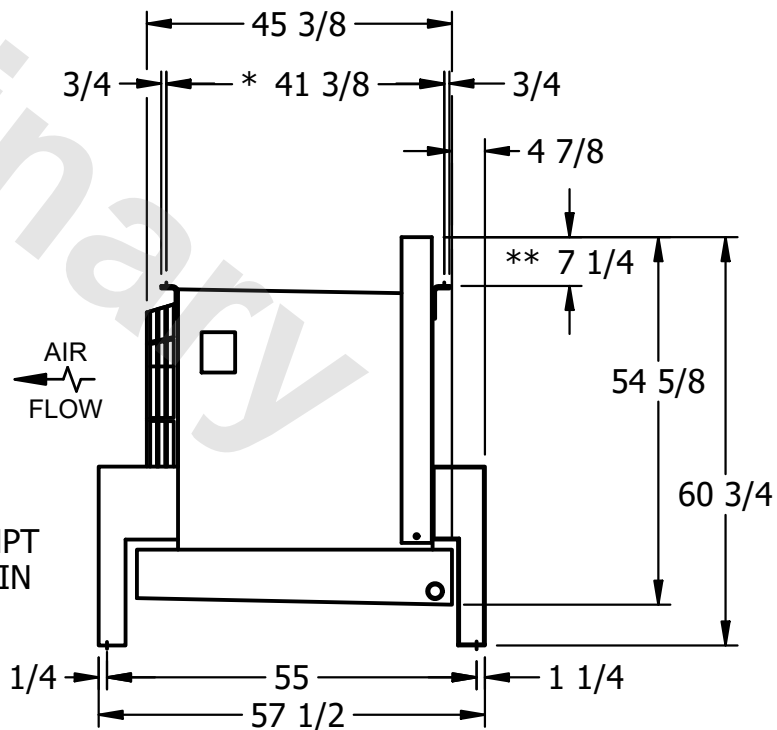

- 1) * = HANGER HOLE LOCATION.
- 2) RIGHT HAND MODEL SHOWN.
- 3) HANGER HOLES ARE FOR 3/4 INCH THREADED ROD.
- 4) WATER DEFROST ADDS 1 3/4" INCHES TO HEIGHT OF STANDARD UNIT AND CHANGES DRAIN SIZE.
- 5) ALL DIMENSIONS ARE FOR REFERENCE AND SHOULD NOT BE USED FOR PREFABRICATION OF PIPING OR SUPPORTS.
- 6) **= HEIGHT OF SUCTION HEADER AND INSTALLED THERMOWELL FITTING ABOVE CABINET. CUSTOMER IS RESPONSIBLE TO ACCOUNT FOR ADDITIONAL HEIGHT NECESSARY FOR RTD AND ACCESS.

ROOM

1230 lbs+ [560] kg+

1400 lbs+ [640] kg+