

This document is the property of Evapco, Inc. It should not be copied or disclosed without prior written authorization.

|         |                         |
|---------|-------------------------|
| MODEL # | U-EJETME2-2183F0200F1LA |
|---------|-------------------------|

DWG. # UEJETM2-SE-16,18

|      |           |
|------|-----------|
| DATE | 7/29/2025 |
|------|-----------|



- NEMA 4X  
JUNCTION BOX

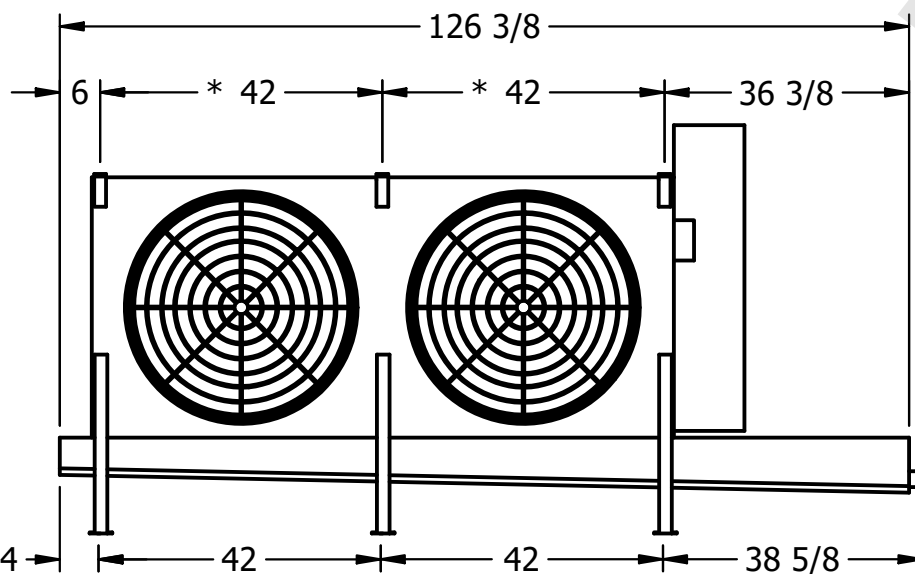

2" MPT  
DRAIN

- 1) \* = HANGER HOLE LOCATION.
- 2) RIGHT HAND MODEL SHOWN.
- 3) HANGER HOLES ARE FOR 3/4 INCH THREADED ROD.
- 4) WATER DEFROST ADDS 1 3/4" INCHES TO HEIGHT OF STANDARD UNIT AND CHANGES DRAIN SIZE.
- 5) ALL DIMENSIONS ARE FOR REFERENCE AND SHOULD NOT BE USED FOR PREFABRICATION OF PIPING OR SUPPORTS.
- 6) \*\*= HEIGHT OF SUCTION HEADER AND INSTALLED THERMOWELL FITTING ABOVE CABINET. CUSTOMER IS RESPONSIBLE TO ACCOUNT FOR ADDITIONAL HEIGHT NECESSARY FOR RTD AND ACCESS.



ROOM

1080 lbs+ [490] kg+

1250 lbs+ [570] kg+