

This document is the property of Evapco, Inc. It should not be copied or disclosed without prior written authorization.

MODEL #	U-EJETME2-16106F0025C1KA
---------	--------------------------

DWG. # UEJETM2-SE-12,14

DATE	9/12/2025
------	-----------



- NEMA 4X
JUNCTION BOX

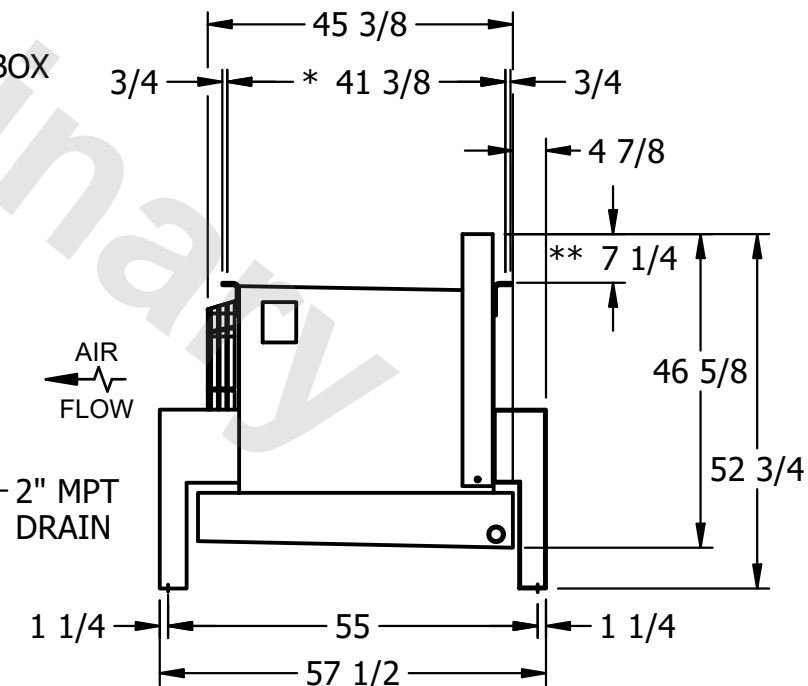
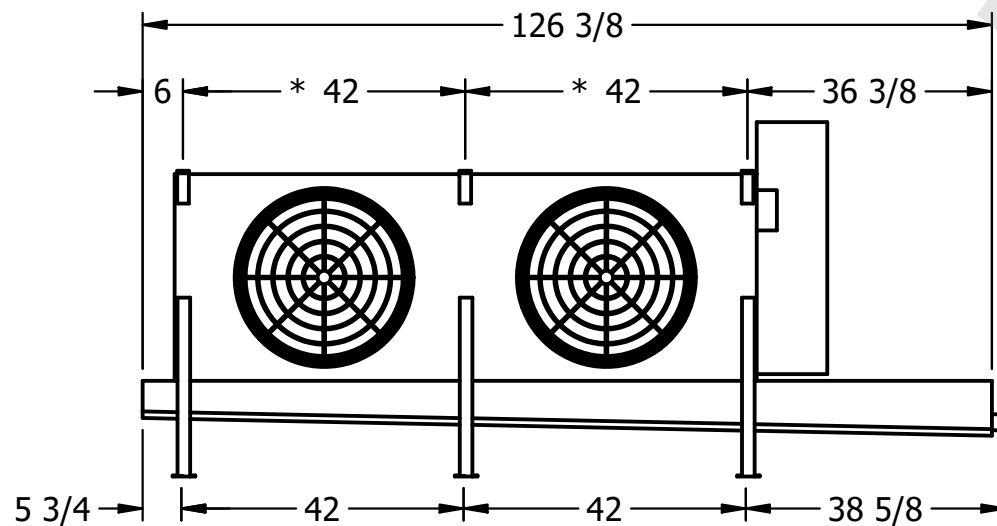

- 1) * = HANGER HOLE LOCATION.
- 2) RIGHT HAND MODEL SHOWN.
- 3) HANGER HOLES ARE FOR 3/4 INCH THREADED ROD.
- 4) WATER DEFROST ADDS 1 3/4" INCHES TO HEIGHT OF STANDARD UNIT AND CHANGES DRAIN SIZE.
- 5) ALL DIMENSIONS ARE FOR REFERENCE AND SHOULD NOT BE USED FOR PREFABRICATION OF PIPING OR SUPPORTS.
- 6) **= HEIGHT OF SUCTION HEADER AND INSTALLED THERMOWELL FITTING ABOVE CABINET. CUSTOMER IS RESPONSIBLE TO ACCOUNT FOR ADDITIONAL HEIGHT NECESSARY FOR RTD AND ACCESS.

ROOM

SHIPPING
WEIGHT

1210 lbs+ [550] kg+

OPERATING WEIGHT	10000
------------------	-------

1460 lbs+ [665] kg+