

EVAPCO, INC.



| | | | | | | |
|--------------------------------------|---------------------|----------------|----------------------------|------|-------------------|----------|
| UNIT EVAPORATIVE CONDENSER | MODEL # CATC-181 | SCALE N.T.S | DWG. # CC2240906-DRC-ST | REV. | DATE 5/21/2026 | SERIAL # |
|--------------------------------------|---------------------|----------------|----------------------------|------|-------------------|----------|

NOTES:

1. (M)- FAN MOTOR LOCATION
2. HEAVIEST SECTION IS PLENUM/CASING SECTION
3. MPT DENOTES MALE PIPE THREAD
FPT DENOTES FEMALE PIPE THREAD
BFW DENOTES BEVELED FOR WELDING
4. +UNIT WEIGHT DOES NOT INCLUDE ACCESSORIES (SEE ACCESSORY DRAWINGS)
5. MAKE-UP WATER PRESSURE
20 psi MIN [137 kPa], 50 psi MAX [344 kPa]
6. *-APPROXIMATE DIMENSIONS DO NOT USE FOR PRE-FABRICATION OF CONNECTING PIPING
7. MAKE-UP IS LOCATED 4 3/4" FROM CONNECTION END.

**FACE 2
PLAN VIEW**

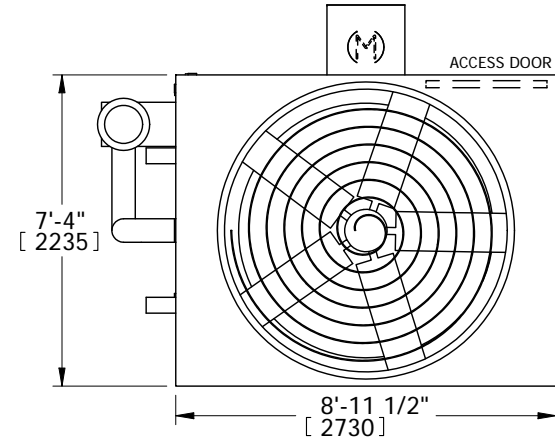

FACE 1

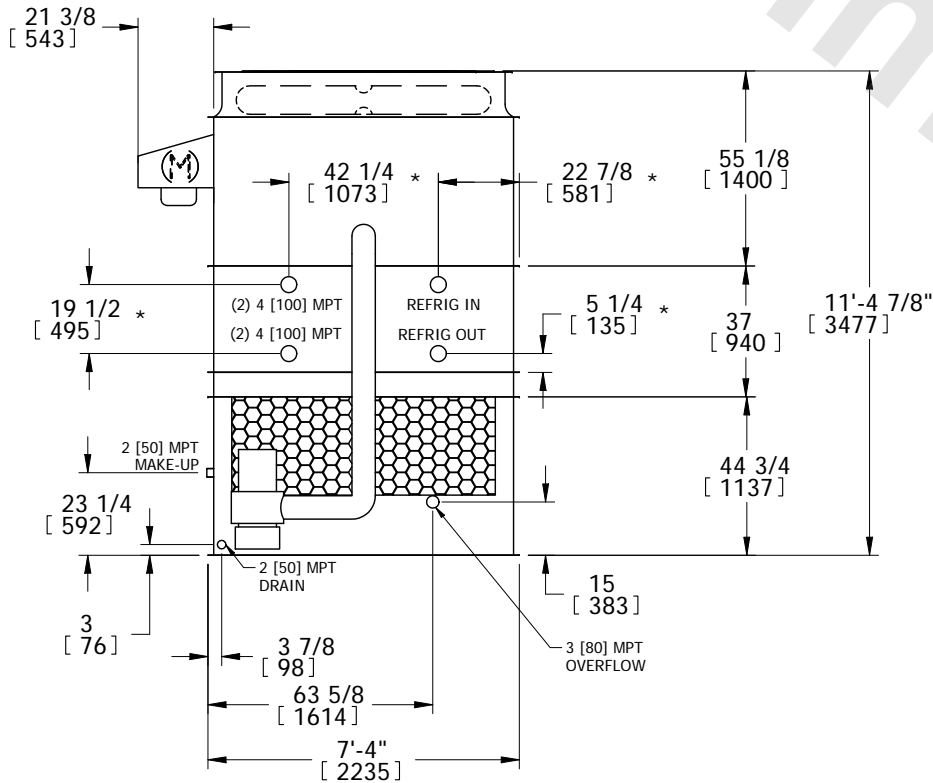

FACE 2

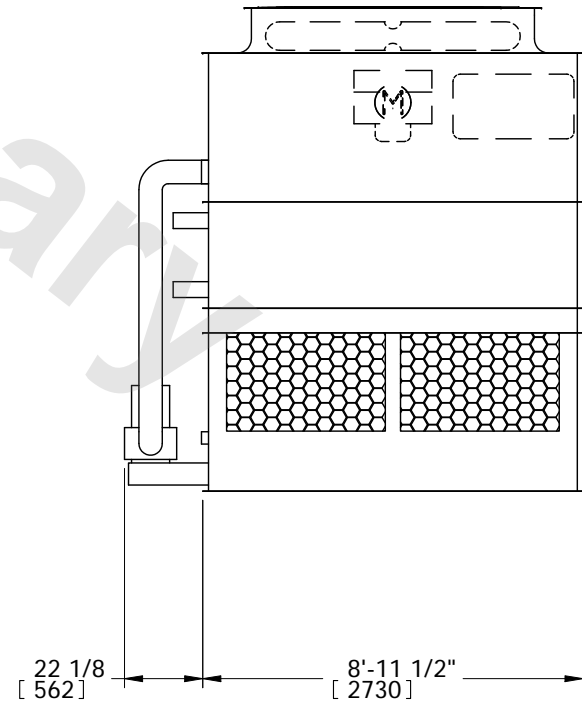

FACE 1

| | | | |
|---|--|---|-------------------------------|
| SHIPPING WEIGHT 7540 lbs+ [3420] kg+ | OPERATING WEIGHT 9140 lbs+ [4145] kg+ | HEAVIEST SECTION WEIGHT 5940 lbs+ [2695] kg+ | NO. OF SHIPPING SECTIONS 2 |
|---|--|---|-------------------------------|