

This document is the property of Evapco, Inc. It should not be copied or disclosed without prior written authorization.

| | |
|---------|--------------------------|
| MODEL # | U-EJETME2-21104F0050F3KA |
|---------|--------------------------|

DWG. # UEJETM2-SE-16,18

| | |
|------|-----------|
| DATE | 9/16/2025 |
|------|-----------|



- NEMA 4X
JUNCTION BOX

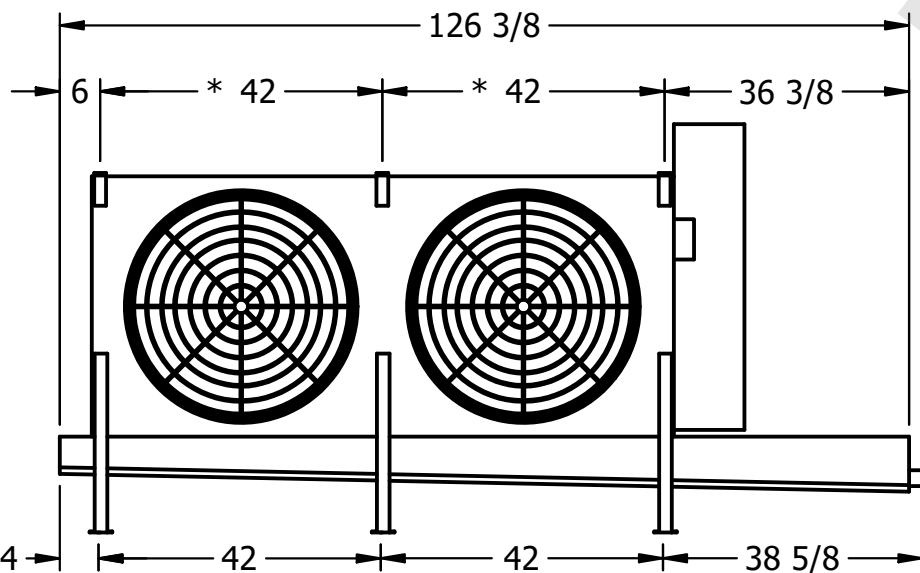

2" MPT
DRAIN

- 1) * = HANGER HOLE LOCATION.
- 2) RIGHT HAND MODEL SHOWN.
- 3) HANGER HOLES ARE FOR 3/4 INCH THREADED ROD.
- 4) WATER DEFROST ADDS 1 3/4" INCHES TO HEIGHT OF STANDARD UNIT AND CHANGES DRAIN SIZE.
- 5) ALL DIMENSIONS ARE FOR REFERENCE AND SHOULD NOT BE USED FOR PREFABRICATION OF PIPING OR SUPPORTS.
- 6) ** = HEIGHT OF SUCTION HEADER AND INSTALLED THERMOWELL FITTING ABOVE CABINET. CUSTOMER IS RESPONSIBLE TO ACCOUNT FOR ADDITIONAL HEIGHT NECESSARY FOR RTD AND ACCESS.

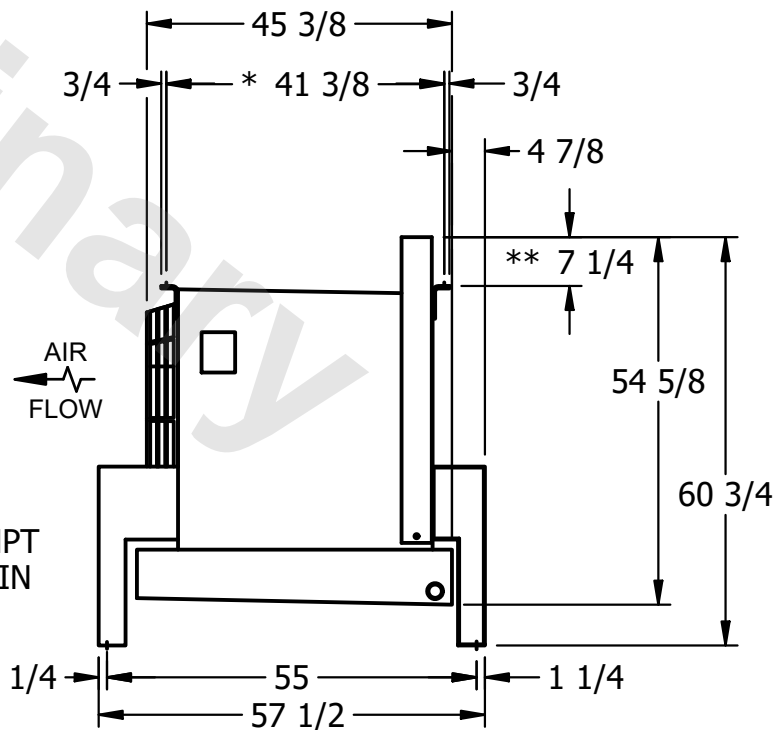

SHIPPING
WEIGHT

1200 lbs+ [545] kg+

| | |
|------------------|-------|
| OPERATING WEIGHT | 10000 |
|------------------|-------|

1450 lbs+ [660] kg+