

This document is the property of Evapco, Inc. It should not be copied or disclosed without prior written authorization.

MODEL #

U-EJETME2-1966F0075F1LA

N.T.S.

UEJETM2-SE-16,18

9/15/2025



- NEMA 4X  
JUNCTION BOX

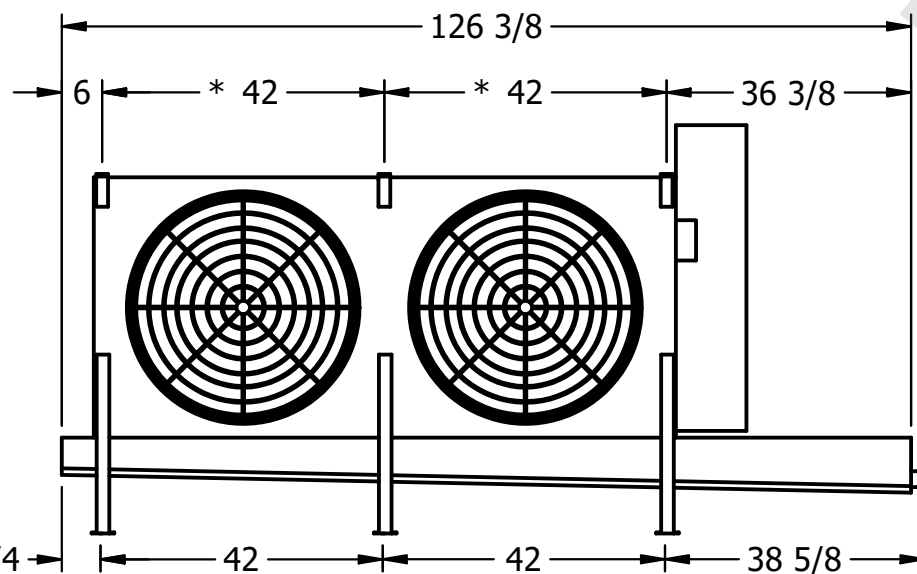

- 2" MPT  
DRAIN

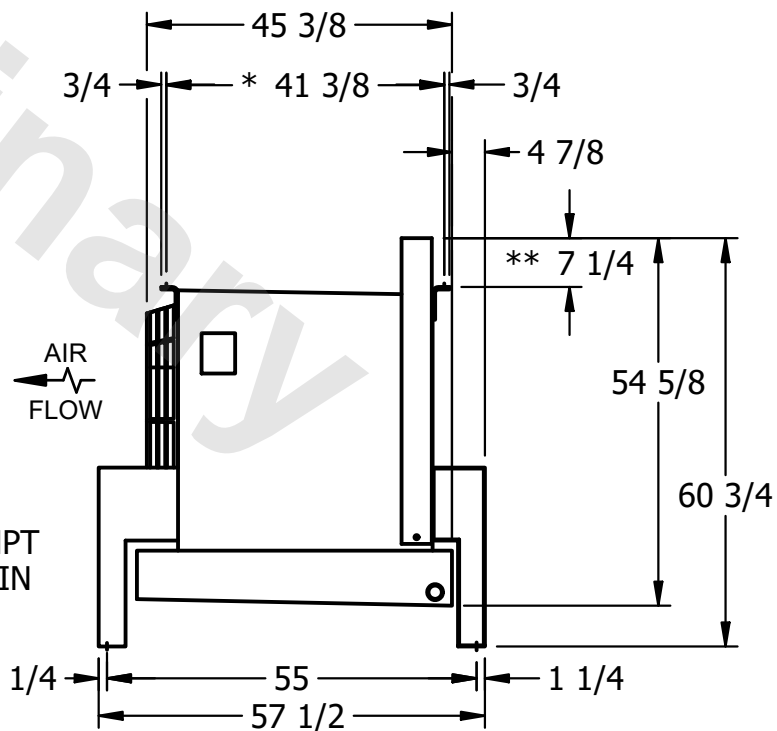

1) \* = HANGER HOLE LOCATION.

2) RIGHT HAND MODEL SHOWN.

2) RIGHT HAND MODEL SHOWN.

3) HANGER HOLES ARE FOR 3/4 INCH THREADED ROD.

4) WATER DEFROST ADDS 1 3/4" INCHES TO HEIGHT OF STANDARD UNIT AND CHANGES DRAIN SIZE.

5) ALL DIMENSIONS ARE FOR REFERENCE AND SHOULD NOT BE USED FOR PREFABRICATION OF PIPING OR SUPPORTS.

6) \*\*= HEIGHT OF SUCTION HEADER AND INSTALLED THERMOWELL FITTING ABOVE CABINET. CUSTOMER IS RESPONSIBLE TO ACCOUNT FOR ADDITIONAL HEIGHT NECESSARY FOR RTD AND ACCESS.

ROOM

SHIPPING  
WEIGHT

990 lbs+ [450] kg+

OPERATING WEIGHT	10,000
------------------	--------

1160 lbs+ [530] kg+