

This document is the property of Evapco, Inc. It should not be copied or disclosed without prior written authorization.

MODEL #	U-EJETME2-2884H0100F1JA
---------	-------------------------

DWG. #	UEJETM2-SE-24
--------	---------------

DATE	7/20/2025
------	-----------

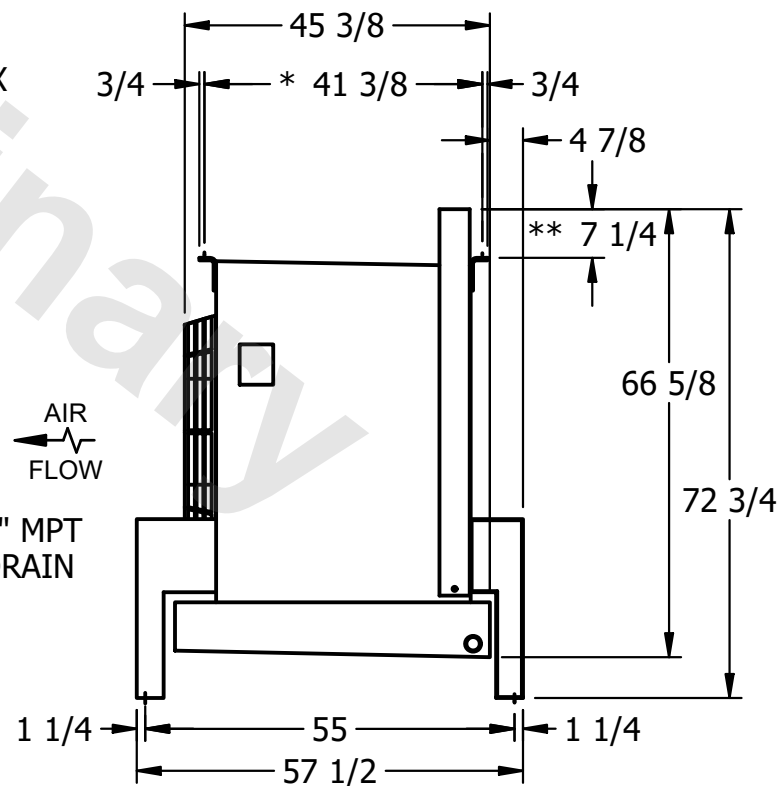
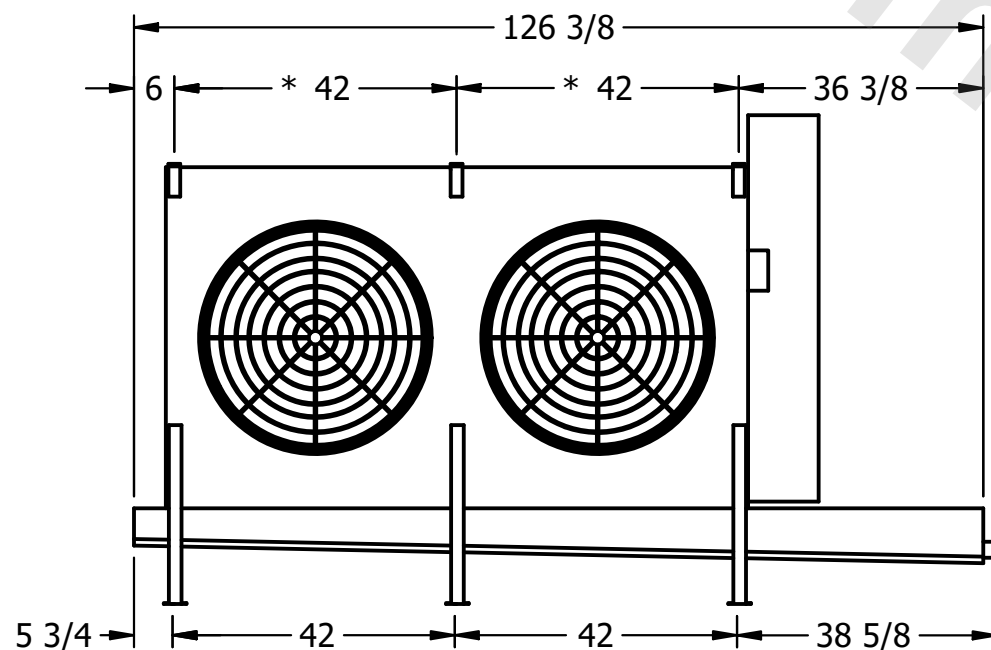

- 1) * = HANGER HOLE LOCATION.
- 2) RIGHT HAND MODEL SHOWN.
- 3) HANGER HOLES ARE FOR 3/4 INCH THREADED ROD.
- 4) WATER DEFROST ADDS 1 3/4" INCHES TO HEIGHT OF STANDARD UNIT AND CHANGES DRAIN SIZE.
- 5) ALL DIMENSIONS ARE FOR REFERENCE AND SHOULD NOT BE USED FOR PREFABRICATION OF PIPING OR SUPPORTS.
- 6) **= HEIGHT OF SUCTION HEADER AND INSTALLED THERMOWELL FITTING ABOVE CABINET. CUSTOMER IS RESPONSIBLE TO ACCOUNT FOR ADDITIONAL HEIGHT NECESSARY FOR RTD AND ACCESS.

SHIPPING
WEIGHT

OPERATING WEIGHT	10,000
------------------	--------

1880 lbs+ [855] kg+