

This document is the property of Evapco, Inc. It should not be copied or disclosed without prior written authorization.

EVAPCO, INC.



CUSTOMER

MODEL #	SSTMB1-11104F0200F2LA
---------	-----------------------

SCALE **N.T.S.**

DWG. #	STMC1-SE-16
--------	-------------

REV. 0

DATE	7/5/2025
------	----------

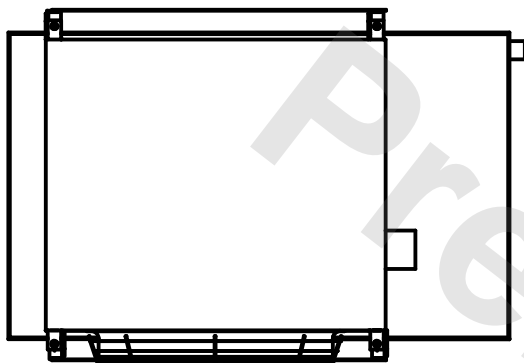

- 1) * = HANGER HOLE LOCATION.
- 2) RIGHT HAND MODEL SHOWN.
- 3) HANGER HOLES ARE FOR 3/4 INCH THREADED ROD.
- 4) WATER DEFROST ADDS 1 3/4" INCHES TO HEIGHT OF STANDARD UNIT AND CHANGES DRAIN SIZE.
- 5) ALL DIMENSIONS ARE FOR REFERENCE AND SHOULD NOT BE USED FOR PREFABRICATION OF PIPING OR SUPPORTS.

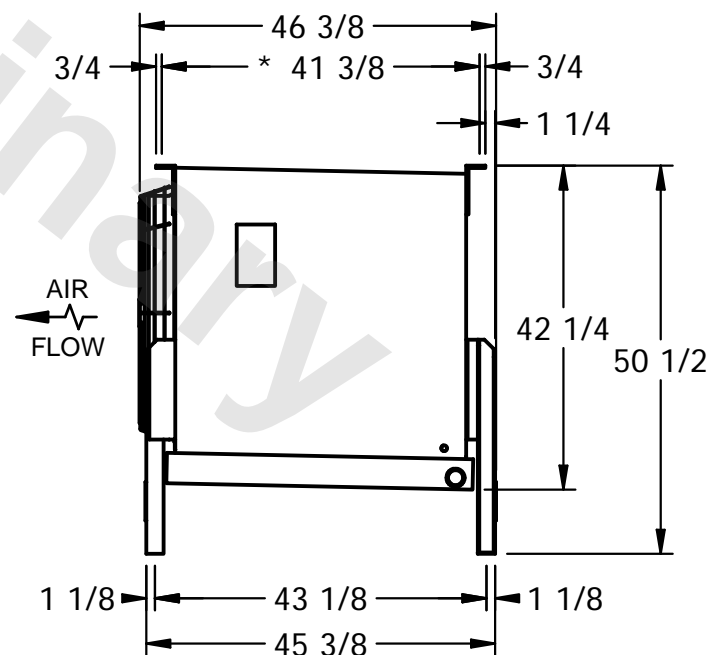

PROJECT

ROOM

SHIPPING WEIGHT	700 lbs
-----------------	---------

OPERATING WEIGHT	830 lbs
------------------	---------