

This document is the property of Evapco, Inc. It should not be copied or disclosed without prior written authorization.

CUSTOMER

MODEL #

U-SSTME2-1944H0100F1KA

SCALE

N.T.S.

DWG. #

USSTM2-SE-16,18

REV. 0

DATE	9/14/2025
------	-----------

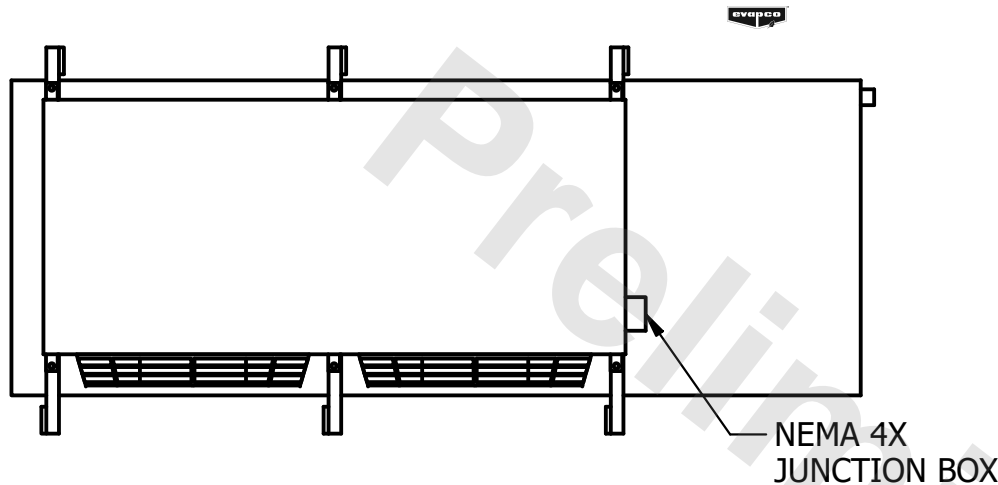

NOTES:

- 1) * = HANGER HOLE LOCATION.
- 2) RIGHT HAND MODEL SHOWN.
- 3) HANGER HOLES ARE FOR 3/4 INCH THREADED ROD.
- 4) ALL DIMENSIONS ARE FOR REFERENCE AND SHOULD NOT BE USED FOR PREFABRICATION OF PIPING OR SUPPORTS.

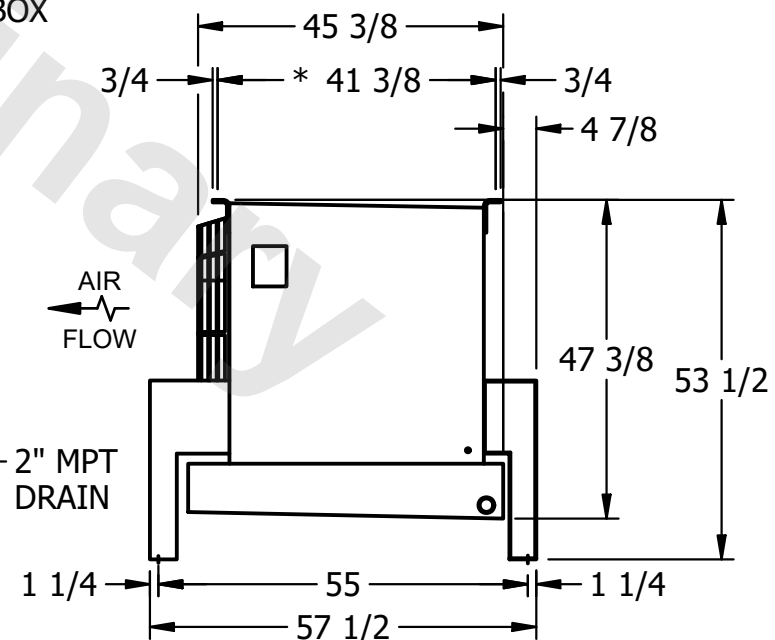
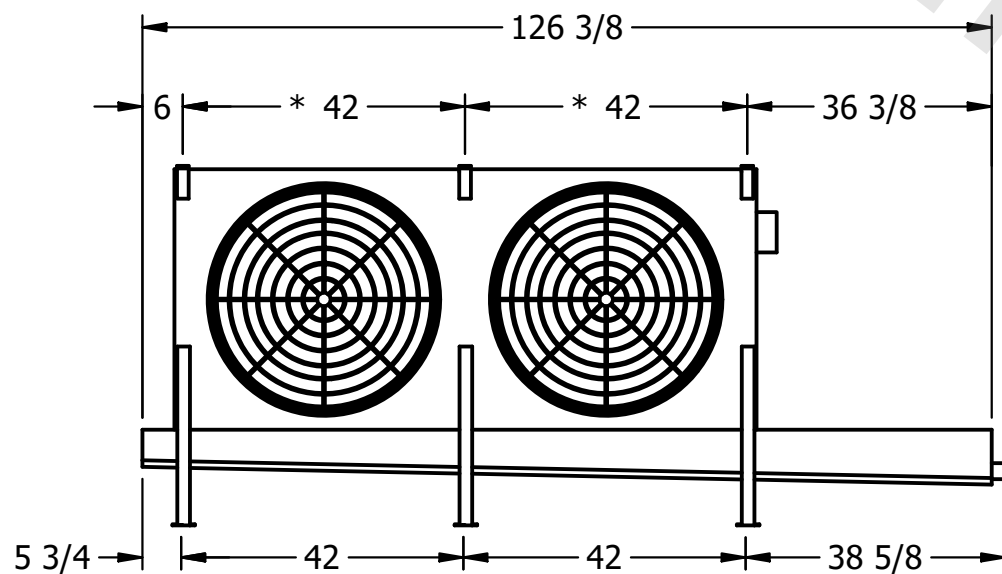

PROJECT

ROOM

SHIPPING
WEIGHT

960 lbs+ [440] kg+

OPERATING WEIGHT	10000
------------------	-------

1050 lbs+ [480] kg+