

This document is the property of Evapco, Inc. It should not be copied or disclosed without prior written authorization.

| | |
|---------|-------------------------|
| MODEL # | U-EJETME2-1644H0200C1MA |
|---------|-------------------------|

DWG. # UEJETM2-SE-12,14

| | |
|------|-----------|
| DATE | 9/13/2025 |
|------|-----------|

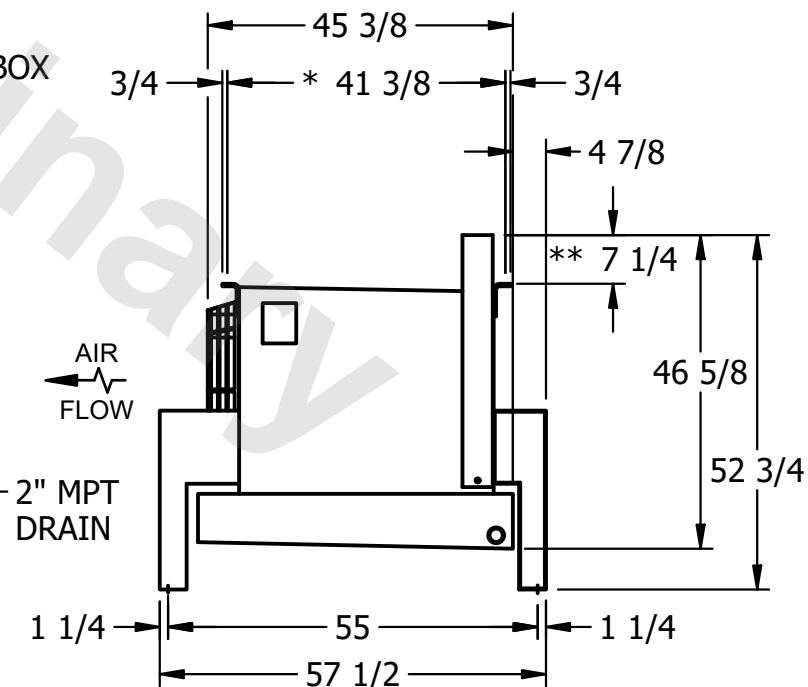
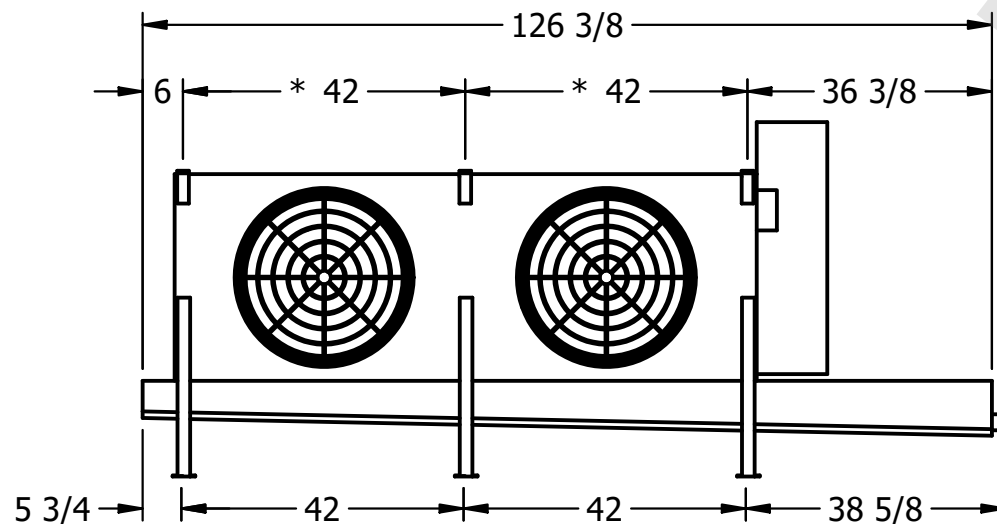

- 1) * = HANGER HOLE LOCATION.
- 2) RIGHT HAND MODEL SHOWN.
- 3) HANGER HOLES ARE FOR 3/4 INCH THREADED ROD.
- 4) WATER DEFROST ADDS 1 3/4" INCHES TO HEIGHT OF STANDARD UNIT AND CHANGES DRAIN SIZE.
- 5) ALL DIMENSIONS ARE FOR REFERENCE AND SHOULD NOT BE USED FOR PREFABRICATION OF PIPING OR SUPPORTS.
- 6) **= HEIGHT OF SUCTION HEADER AND INSTALLED THERMOWELL FITTING ABOVE CABINET. CUSTOMER IS RESPONSIBLE TO ACCOUNT FOR ADDITIONAL HEIGHT NECESSARY FOR RTD AND ACCESS.

SHIPPING
WEIGHT

970 lbs+ [440] kg+

1040 lbs+ [475] kg+