

This document is the property of Evapco, Inc. It should not be copied or disclosed without prior written authorization.

MODEL #	U-EJETME2-16103F0033C1KA
---------	--------------------------

DWG. # UEJETM2-SE-12,14

DATE	9/12/2025
------	-----------

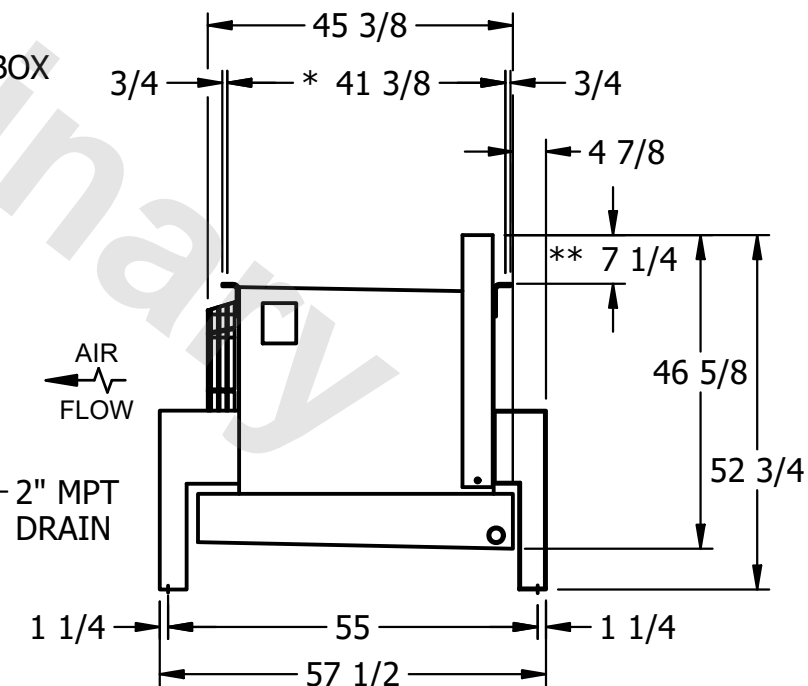
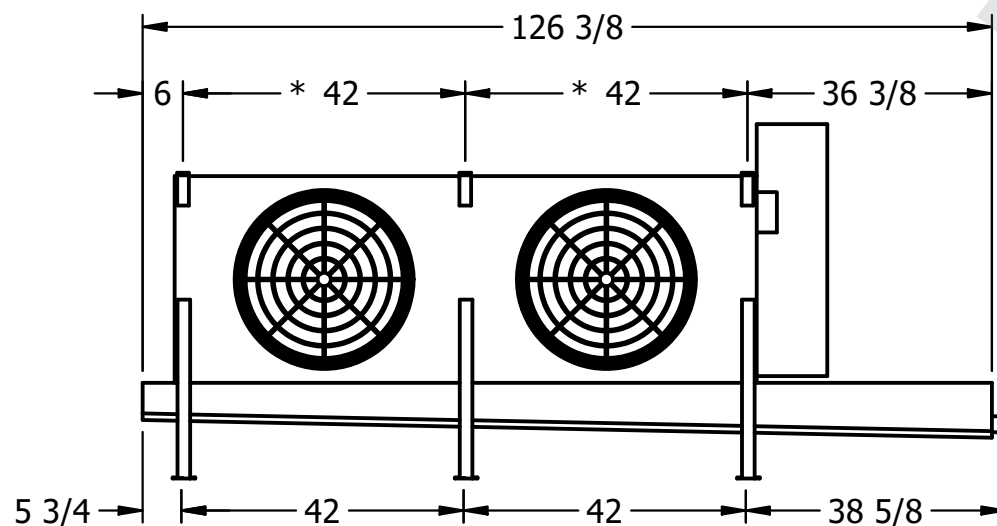

- 1) \* = HANGER HOLE LOCATION.
- 2) RIGHT HAND MODEL SHOWN.
- 3) HANGER HOLES ARE FOR 3/4 INCH THREADED ROD.
- 4) WATER DEFROST ADDS 1 3/4" INCHES TO HEIGHT OF STANDARD UNIT AND CHANGES DRAIN SIZE.
- 5) ALL DIMENSIONS ARE FOR REFERENCE AND SHOULD NOT BE USED FOR PREFABRICATION OF PIPING OR SUPPORTS.
- 6) \*\*= HEIGHT OF SUCTION HEADER AND INSTALLED THERMOWELL FITTING ABOVE CABINET. CUSTOMER IS RESPONSIBLE TO ACCOUNT FOR ADDITIONAL HEIGHT NECESSARY FOR RTD AND ACCESS.

SHIPPING  
WEIGHT

1060 lbs+ [485] kg+

1220 lbs+ [555] kg+